

How to setup smartermail on Android

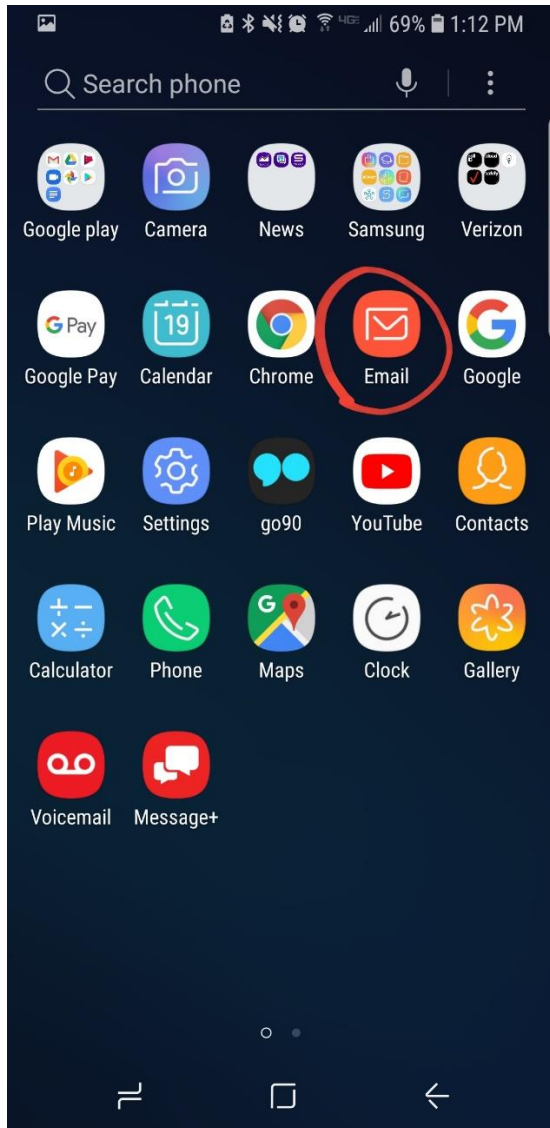

1....Tap **Email**.

How to setup smartermail on Android

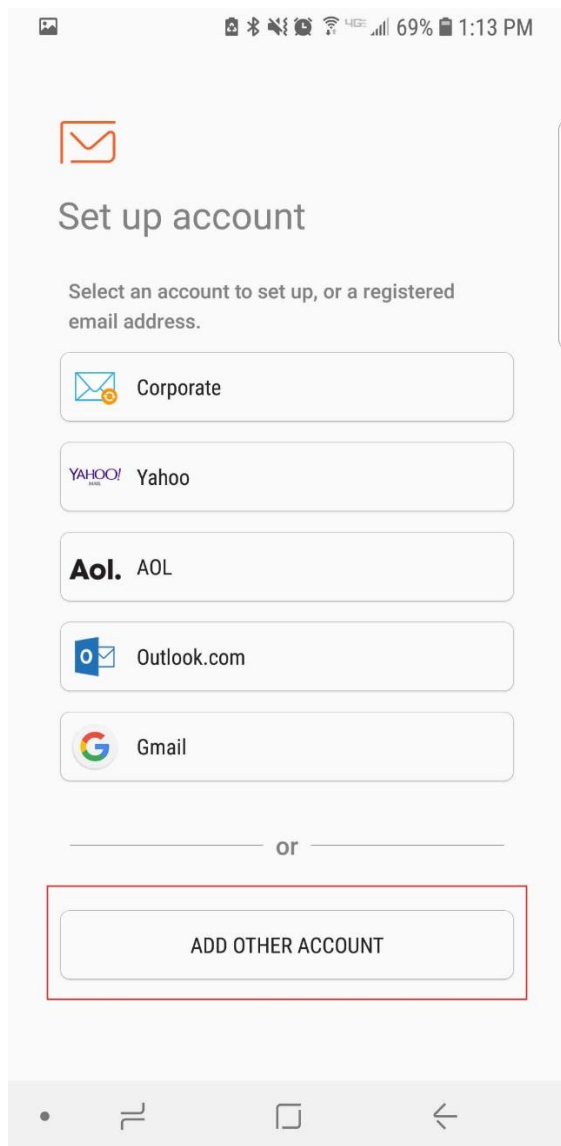

2....Tap **Add Other Account**.

How to setup smartermail on Android

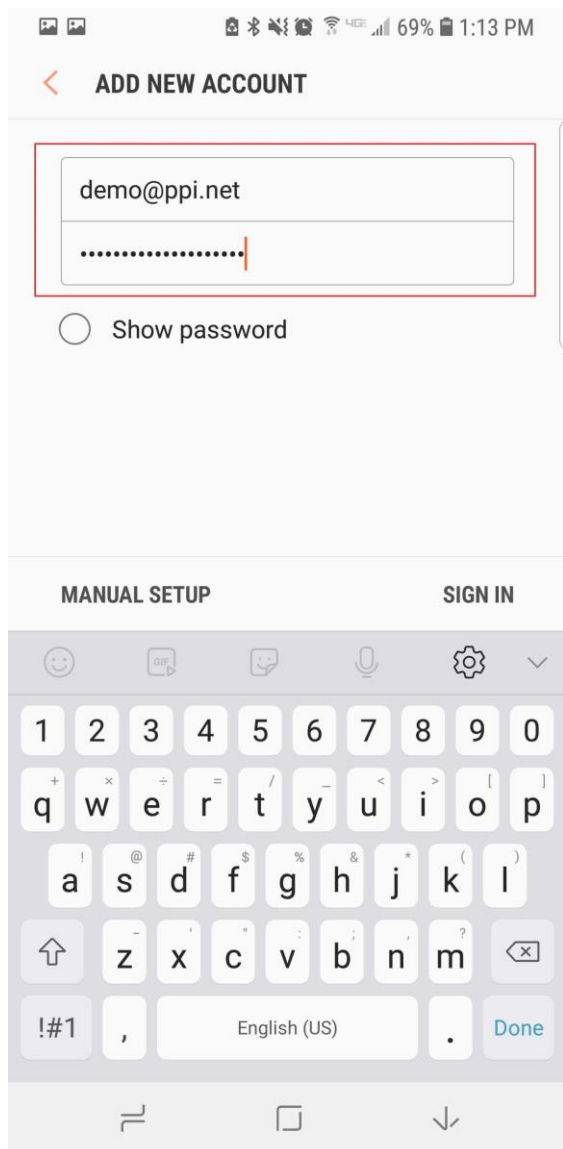

3....Enter your full e-mail address and password.

How to setup smartermail on Android

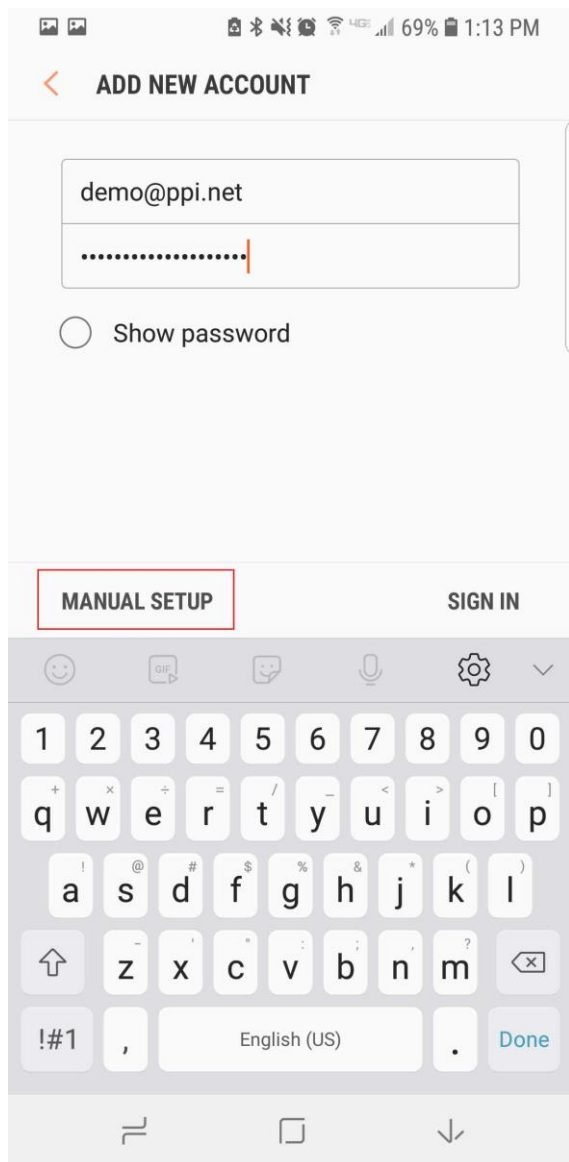

4....Tap **Manual Setup**.

How to setup smartermail on Android

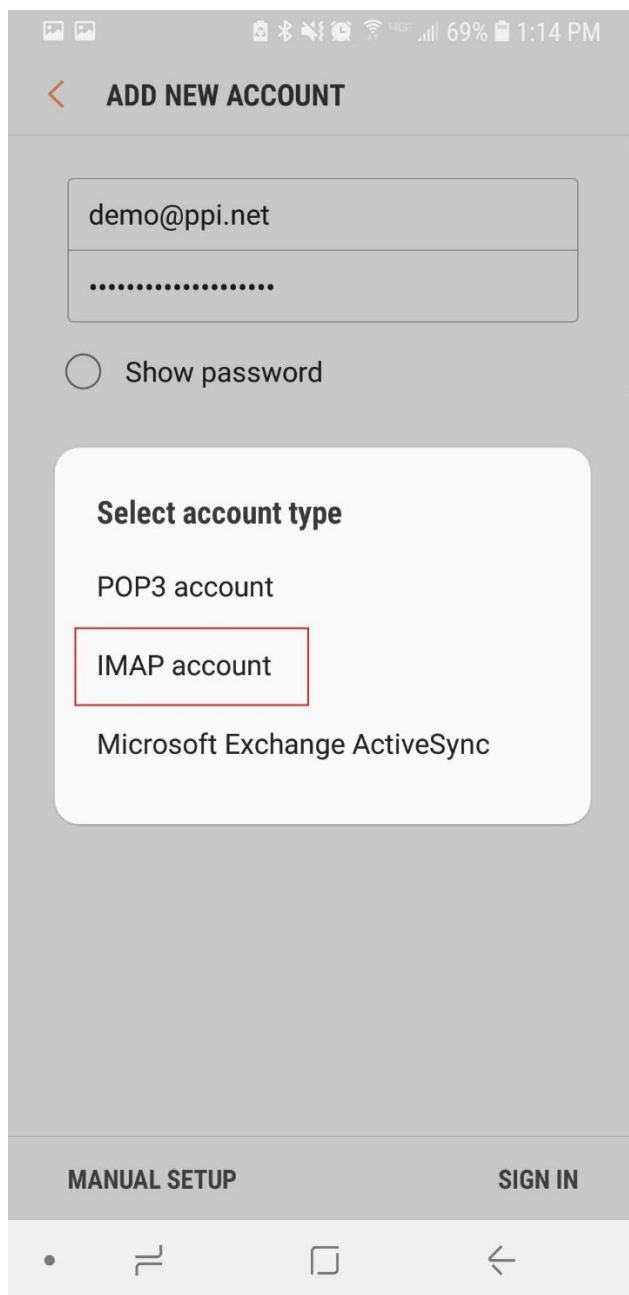

5....Tap **IMAP Account**.

How to setup smartermail on Android

SERVER SETTINGS

ACCOUNT

Email address
demo@ppi.net

User name
demo@ppi.net

Password
.....

Show password

INCOMING SERVER

IMAP server
mail.ppi.net

Security type
TLS ▼

Port
143

IMAP path prefix
Optional

NEXT

6....User name - **must be full email address**

How to setup smartermail on Android

SERVER SETTINGS

ACCOUNT

Email address
demo@ppi.net

User name
demo

Password
.....

Show password

INCOMING SERVER

IMAP server
mail.ppi.net

Security type
TLS ▼

Port
143

IMAP path prefix
Optional

NEXT

7....Under **Incoming Server** make sure you have the following settings:

IMAP Server:

Please access to your webmail for example <http://mail.domain.com>. It will forward to a secure url like <https://s1378.securessl.net>
Your Imap server host name will be : s1378.securessl.net

Security Type: TLS

Port:143

Note:

If the above port not working, you may try alternative as below

Security Type: SSL

Port:993

How to setup smartermail on Android

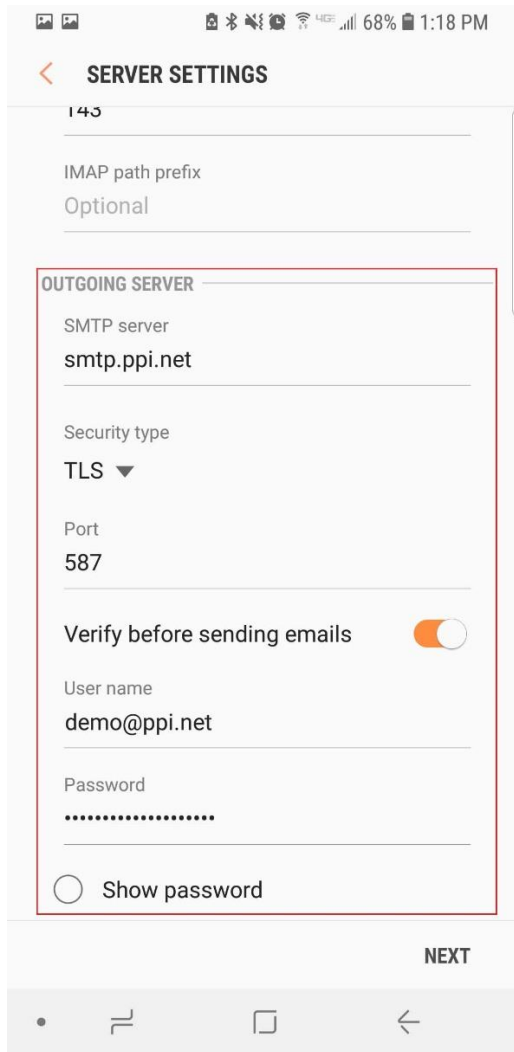

Scroll down and under **Outgoing Server** make sure you have the following settings:

Outgoing Server:

Please access to your webmail for example <http://mail.domain.com>. It will forward to a secure url like <https://s1378.securessl.net>

Your Imap server host name will be : s1378.securessl.net

Security Type: TLS

Port: 587

User Name: Enter your full e-mail address

Verify before sending emails: Toggle on

Verify Username and password are correct.

8...Tap **Next**.

How to setup smartermail on Android

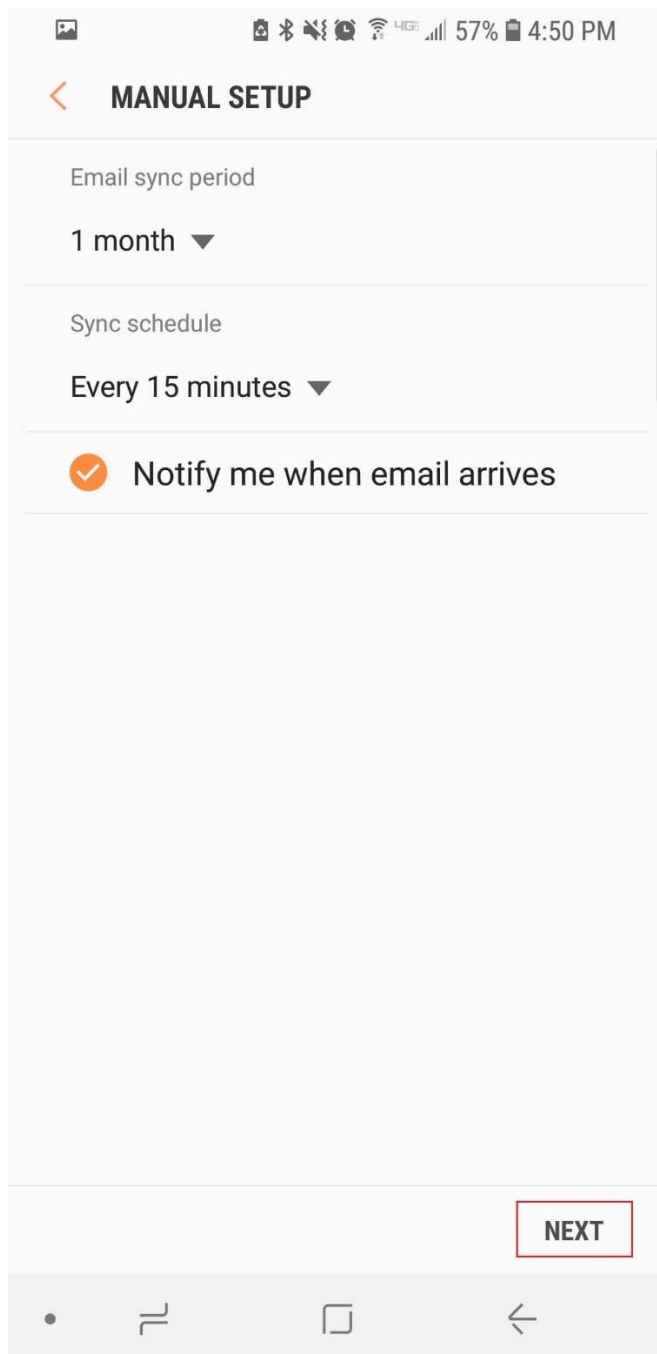

9....Under Manual Setup tap **Next**.

How to setup smartermail on Android

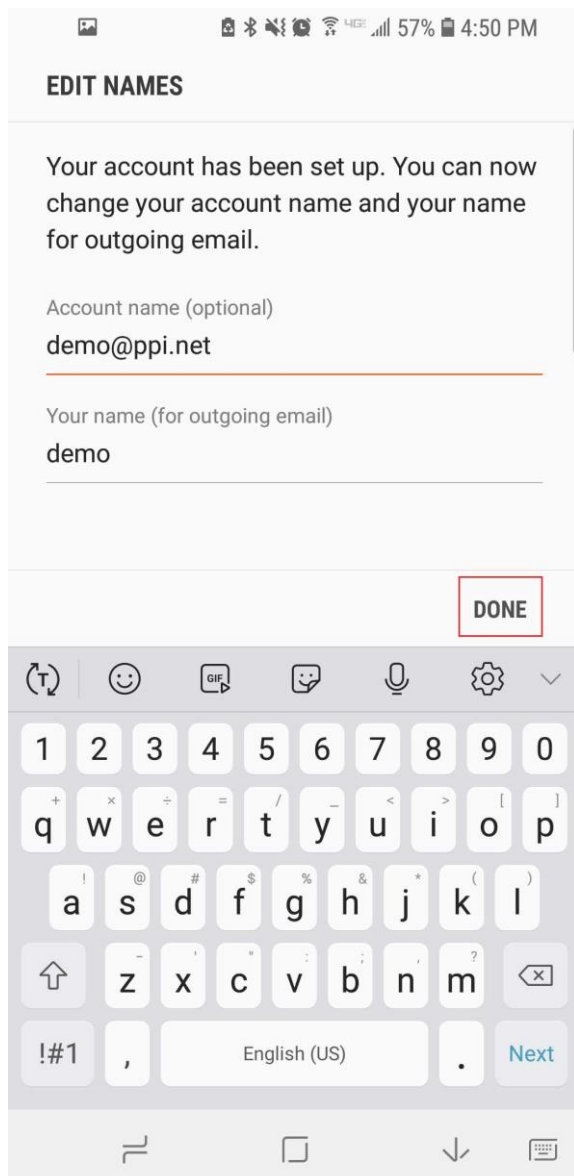

11....On the Edit Names screen you can change the Account Name and Your Name to better identify your email box on your device. Tap **Done** to complete set-up.